



Assembly and Installation Instructions for Model's

30020/1/2FM

Warning please make sure the electrical breaker is shut off before commencing with this installation

CAUTION - RISK OF FIRE

Installation of this fixture should be done by a licensed electrician or by a person familiar with local electrical codes and the construction and operation of this fixture.

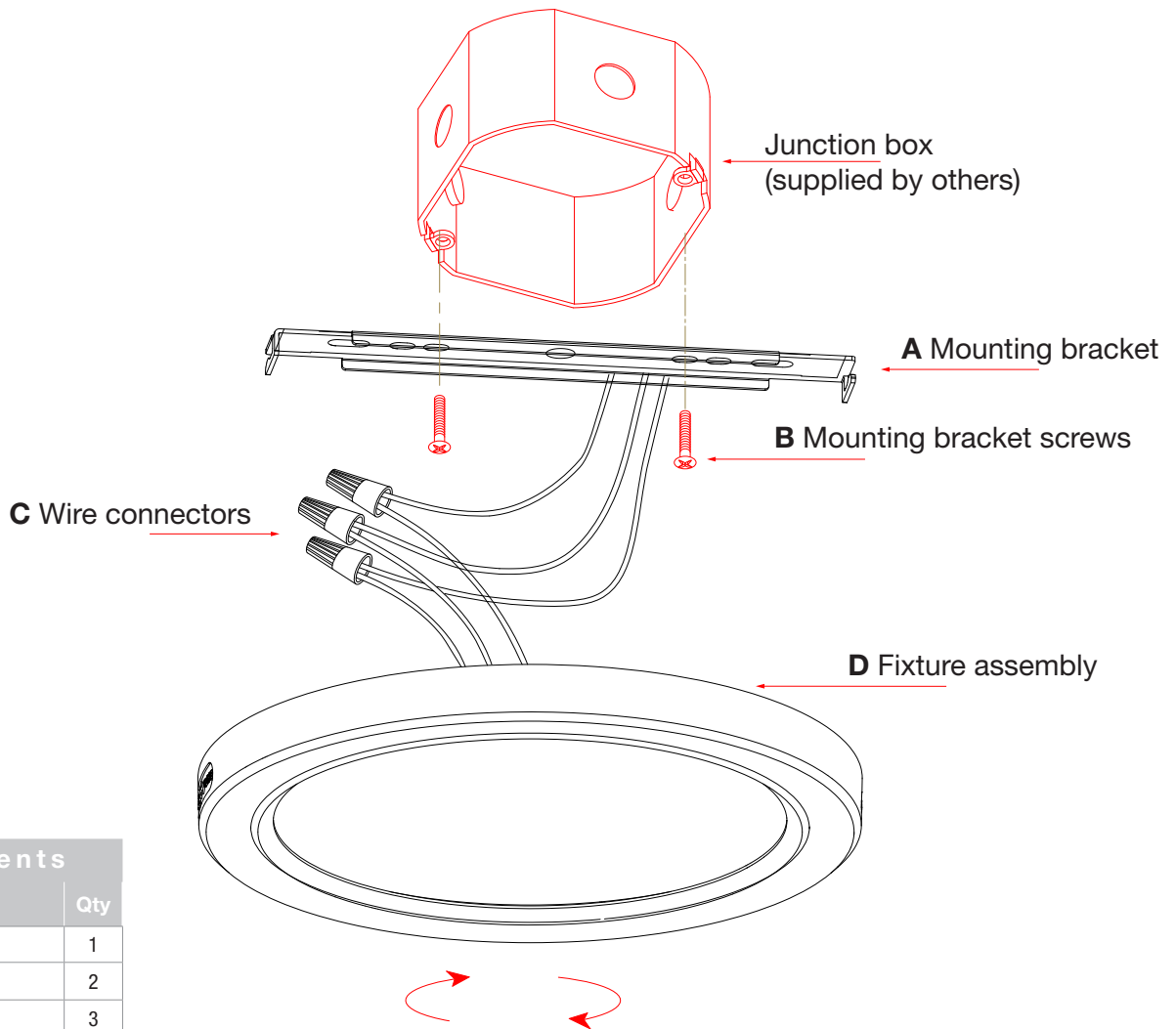

Package Contents		
Part	Description	Qty
A	Mounting bracket	1
B	Mounting bracket screws	2
C	Wire connectors	3
D	Fixture assembly	2

Installing the fixture *please ensure the electrical breaker is switched off before commencing*

- 1 Attach the supplied Mounting bracket (**A**) to the Junction-Box. And secure in place with the two supplied Mounting bracket screws (**B**).
- 2 Connect the supply wires to the fixture wires using the supplied electrical wire connectors (**C**). White supply wire to the White fixture wire, Black supply wire to Black fixture wire and the ground Bare Copper or Green wire to the Green fixture wire. Once the electrical wire connectors are securely fastened it is recommended to tape these connectors with electrical tape.
- 3 Attach the Fixture assembly (**C**) to the Mounting bracket (**A**) by inserting the tabs on the ends of the Mounting bracket through the holes provided on the Fixture assembly and secure by gently twist in a clockwise direction,
- 4 Switch on the electrical breaker switch and your new fixture is ready for many years of trouble free use.